

M10 Clamp plate
M300-2366565 (including bolt)

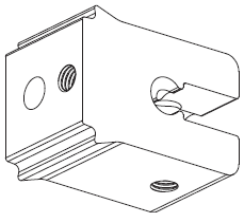

**40 mm bracket for signs clamped in groove or
screwed at 90 degrees to face**
M300-40 (includes clamp plate and bolts)

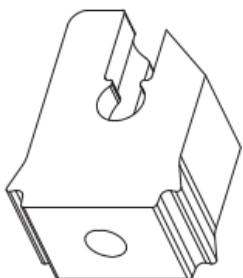

30 mm bracket for signs at 45°
M300-30 (includes clamp plate and bolts)

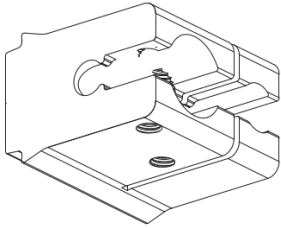

70 mm bracket for banner and CCTV arms
M300-70 (includes clamp plate and bolts)

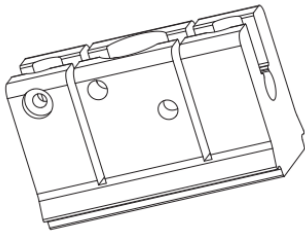

105 mm bracket for banner and CCTV arms
M300-105 (includes clamp plate and bolts)

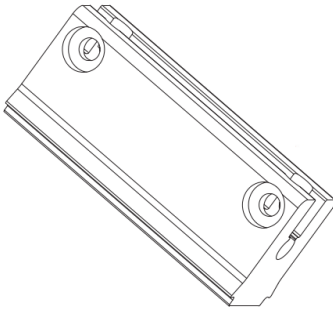

135, 150 or 225 mm bracket for street signs
(includes clamp plates and bolts)



Banner eye assembly
MP-BANNER EYE ASSEMBLY (includes clamp plate and bolt)



Bicycle hoop
MPBIKERING (includes fasteners)